

Index No.	Part No.	Description
1.	57-861530-000	Switch Cluster Assembly
2.	17-204243-000	Dual Gear
3.	N.A.	Retaining Ring
4.	57-214024-000	Cam Shaft Assembly
5.	57-214025-000	Cam Shaft Only
6.	17-204244-000	N.A. Gear Only
7.	17-204234-000	Switch Plate Assembly
8.	10-616051-000	Nut Plate (4-40)
9.	11-617501-000	Fabric Insulator
10.	11-616015-000	Micro-Switch
11.	11-199000-001	Internal Tooth Lockwasher (#4)
12.	11-010509-001	Hex Hd. Washer Machine Screw (4-40 x 3/4")
13.	11-010513-001	Hex Hd. Washer Machine Screw (4-40 x 1-1/4")
14.	11-010022-001	Sltd. Hex Hd. Machine Screw (6-32 x 3/8")
15.	11-195006-001	Lockwasher (#6)
16.	11-190528-001	Flat Washer
17.	10-386107-000	N.A. Spacer (25/64 x 1/16)
18.	57-214227-000	Switch Cam (36° to 136°)
19.	11-420141-000	Oilite Bearing (.3765 I.D. x .503 O.D.)
20.	17-204237-000	Switch Cam (0° to 270°)
21.	11-420138-000	Oilite Bearing (.3775 I.D. x .503 O.D.)
22.	11-195014-001	Lockwasher (1/4")
23.	11-125100-001	Hex Nut (1/4-20)
24.	11-001186-001	Hex Hd. Cap Screw (1/4-20 x 1-1/4")
25.	11-613510-000	Terminal Tab
26.	11-609302-000	N.A. Terminal Bushing (115 Volt)
27.	N.A.	Dual Switch Pivot Assembly
28.	12-750362-000	Mercury Switch
29.	53-100247-000	Mercury Switch Assembly
30.	11-680103-000	Connector Plug (3 Contacts)
31.	11-680302-000	N.A. Terminal
	57-860032-000	R.O. Terminal - Male (Pkg. of 10)
32.	11-230001-001	X-Washer (1/8)
33.	12-750337-000	Latch Assembly
34.	12-450051-000	Tension Spring
35.	12-750364-000	Switch Plate Assembly
36.	53-100435-000	N.A. Switch Support
	12-860563-000	R.O. Micro Switch Assembly
37.	11-674995-000	Push Button Switch
38.	53-520506-000	N.A. Deck Cable Assembly
39.	11-680218-000	N.A. Receptacle (12 Contacts)
40.	11-680301-000	N.A. Terminal
	57-860031-000	R.O. Terminal - Female (Pkg. of 20)
41.	11-680003-000	N.A. Connector Plug (12 Contacts)
42.	11-612301-000	Contact
43.	N.A.	Adapter Cable Assembly
44.	53-520508-000	A/P Control Cable Assembly
45.	N.A.	Receptacle (24 Contacts)
46.	11-612252-000	N.A. Receptacle
47.	11-680201-000	Receptacle (3 Contacts)
48.	11-605127-000	Cable Clamp
49.	11-623005-000	90° Angle Plug
50.	12-750369-000	N.A. Cable Clip

N.A. = No Longer Available

## "2000" Switch Cluster Assembly, Dual Strike Mechanism & Harness Assemblies

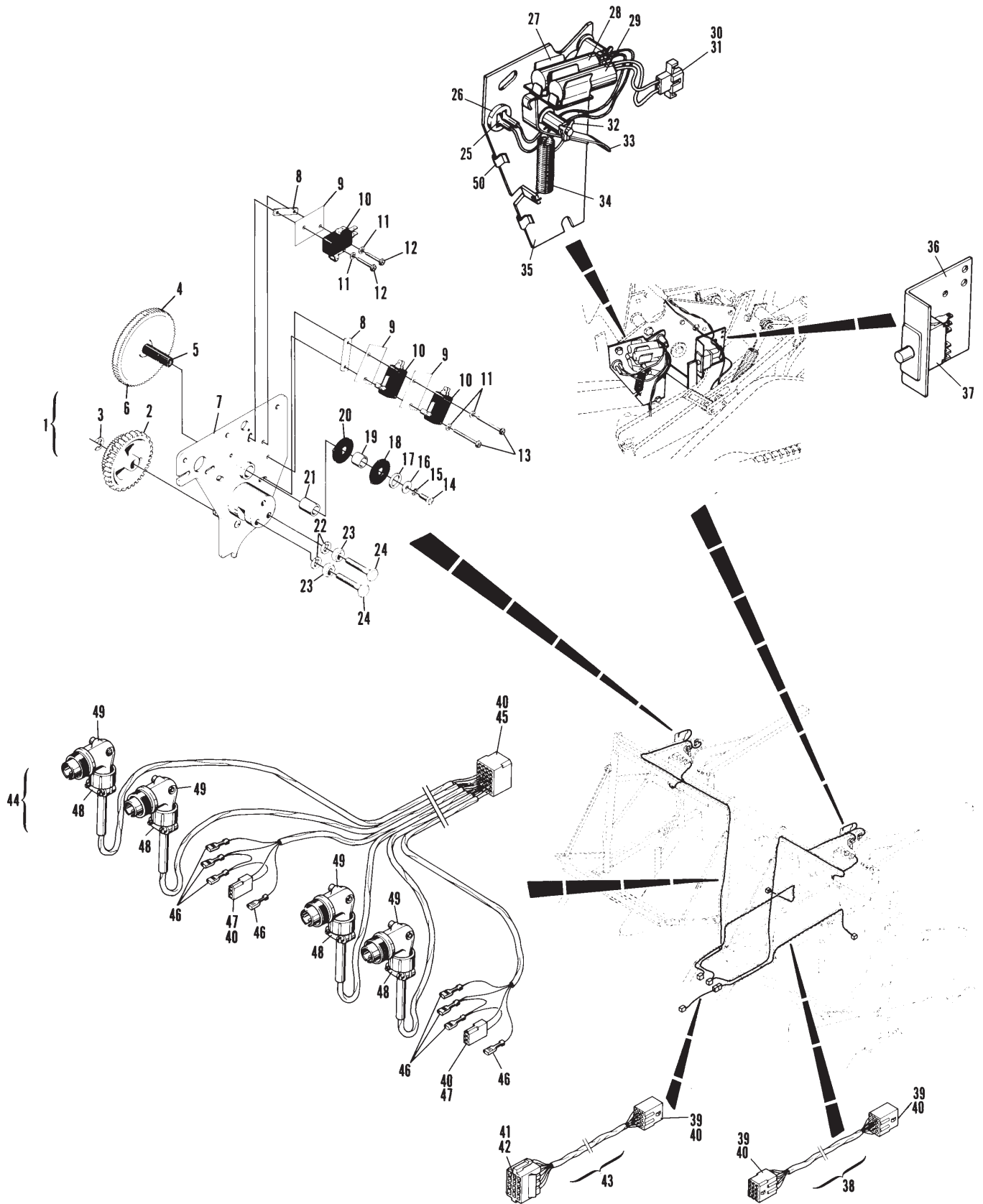

**"2000" Switch Cluster Assembly,  
Dual Strike Mechanism & Harness Assemblies**