

**Index**

<b>No.</b>	<b>Part No.</b>	<b>Description</b>
1.	84-200465-xxx	Cosmetic Cover (31.25")
2.	84-860689-000	N.A. Pkg. Rails Vertical Support and Hardware - Foul End
	84-200452-xxx	L.H. Foul End Rail
	84-200453-xxx	R.H. Foul End Rail
	84-200451-xxx	L.H. & R.H. Common Rail
	84-200478-xxx	L.H. Pinsetter End Rail
	84-200479-xxx	R.H. Pinsetter End Rail
3.	84-860719-000	Pkg of 28 - Metal Vertical Support w/Washers and Rubber Bushings
	84-860454-001	Vertical Support - Lexan (right side of lane)
	84-200454-002	Vertical Support - Lexan (left side of lane)
4.	84-860733-000	Short Vertical (first) Support Pkg. (lane pair)
5.	84-200487-000	Noise Reducing Bushing
6.	11-190509-001	Flat Washer
7.	84-200457-000	Rail Coupler
8.	11-537050-000	Retaining Ring
9.	84-200458-003	Rail Coupler Pin (1-1/16" length)
10.	84-200542-000	Shaft Collar PBW I
11.	84-200515-000	Cross Lane Link PBW I
12a.	84-860645-001	Driven Pivot Assembly w/o Motor (right-hand side of even lane) PBW I
12b.	84-860645-002	Driven Pivot Assembly w/o Motor (left-hand side of odd lane) PBW I
13.	84-200459-000	Gutter Arm Pin (2" length)
14.	84-200460-000	End Rail Insert
15.	84-200458-001	Rail Arm Pin (1-1/4" length)
16.	84-200463-001	R.H. Rail Plug (Pkg. of 10)
	84-200463-002	L.H. Rail Plug (Pkg. of 10)
17.	11-082390-000	N.A. Screw (#8-18 x 1/2")
18.	84-200488-xxx	Safety Warning Label 2
19.	11-682561-000	Safety Warning Label 1 - Call for details in language
20.	84-200462-000	Gutter Coupler
21.	84-200513-000	"D" Shaft (non-pivot side)
22.	84-200472-000	E-Clip Installation Tool

*N.A. = No Longer Available*

Part No.Suffix	Color
-000	BLACK
-100	DARK GRAY
-142	MEDIUM GRAY

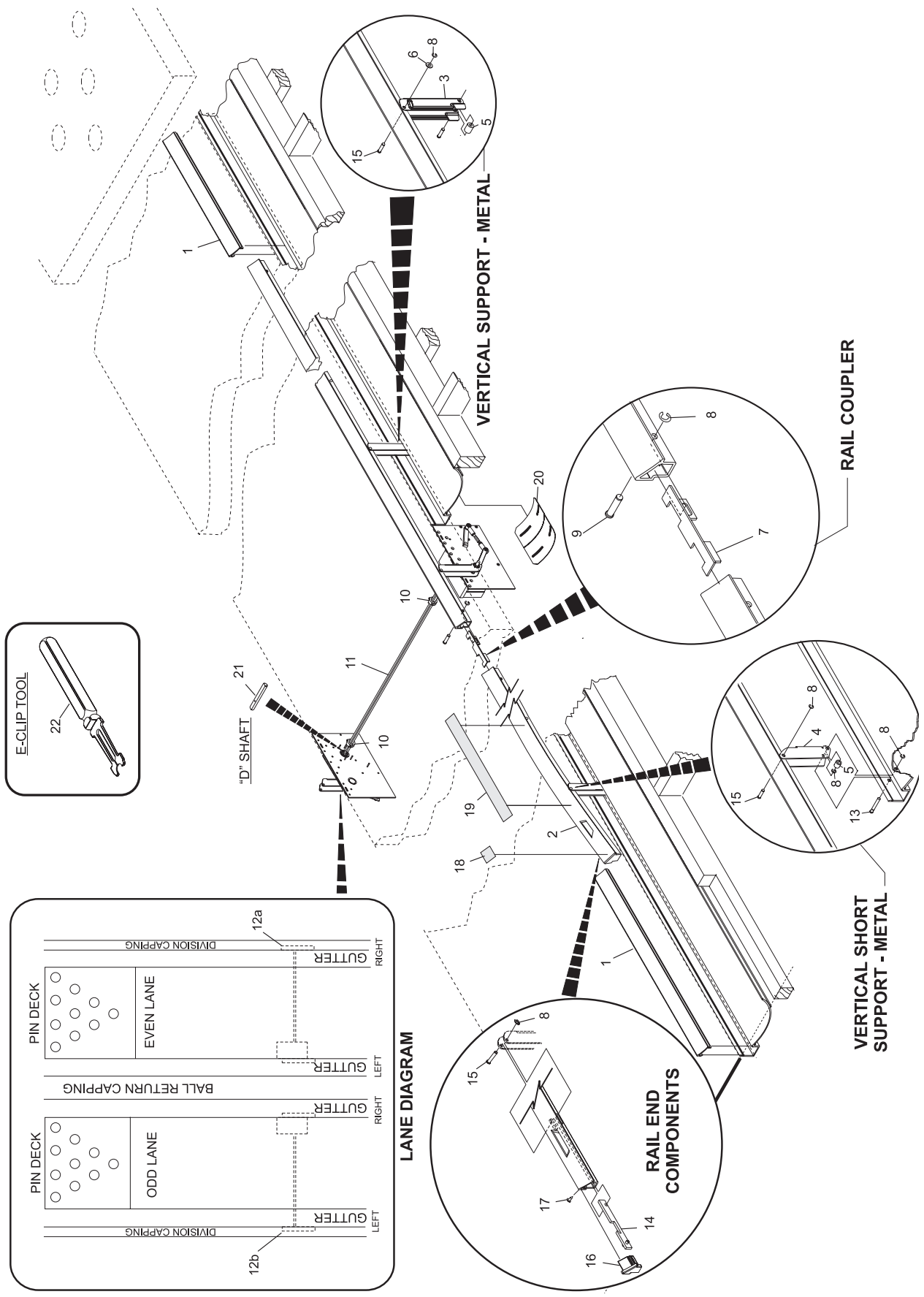

**Pinball Wizard I Gutters -  
Automated Bumpers System**